



JASIC[®]
EVO2.0



TR-01 & TR-02
Assembly Instructions



Your new product



Scan me!

Thank you for selecting this Jasic EVO 20 product.

This product manual has been designed to ensure that you get the most from your new product. Please ensure that you are fully conversant with the information provided paying particular attention to the safety precautions. The information will help protect yourself and others against the potential hazards that you may come across.

Please ensure that you carry out daily and periodic maintenance checks to ensure years of reliable and trouble free operation.

Please call your Jasic distributor in the unlikely event of a problem occurring. Please record below the details from your product as these will be required for warranty purposes and to ensure you get the correct information should you require assistance or spare parts.

Date purchased _____

From where _____

www.jasic-warranty.co.uk

Disclaimer

Whilst every effort has been made to ensure that the information contained within this manual is complete and accurate, no liability can be accepted for any errors or omissions.

Please Note:

Products are subject to continual development and may be subject to change without notice. Regularly check our product pages at www.jasic.co.uk for revision updated operating manuals.

No part of this manual may be copied or reproduced by any means without the written permission of Wilkinson Star Limited.

PACKAGE CONTENTS AND UNPACKING

Supplied within your new Jasic EVO product package will be the following items.

Use care when unpacking the contents and ensure all items are present and not damaged.

If damage is noted or items are missing, please contact the supplier in the first instance and before installing or using the product.

If applicable, record the product model, serial numbers and purchase date in the information section found on the inside front page of this assembly instruction manual.

Jasic EVO TR-01 & TR-02 Trolley

(To be used with the Jasic EVO ET-200P ACDC welding and EP-45SC cutting machines).

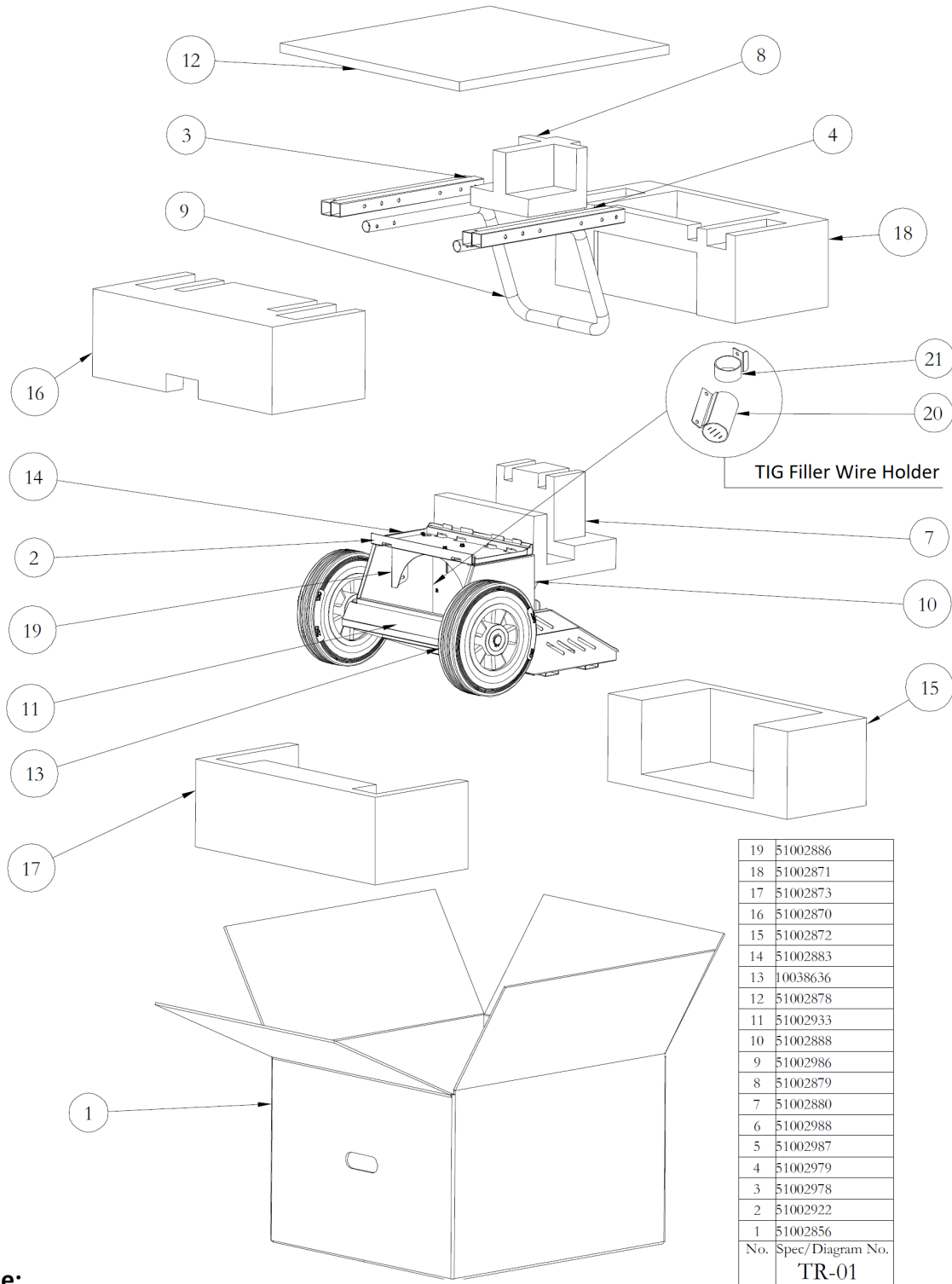

Please Note:

Package contents may vary depending on country location and package part number purchased

ASSEMBLY INFORMATION

For further information refer to the operating manual of the product you are fitting this trolley too.

<p>Quick guide for TR-01</p>	<p>M6×10 4PCS</p> <p>1</p>	<p>M6×40 6PCS</p> <p>2</p>	<p>3</p>
<p>M6×40 4PCS</p> <p>4</p>	<p>M6×40 4PCS</p> <p>5</p>	<p>M6×40 4PCS</p> <p>6</p>	<p>7</p>
<p>8</p>	<p>9</p>	<p>10</p>	<p>11</p>
<p>12</p>	<p>13</p>	<p>14</p>	<p>15</p>

ASSEMBLY INFORMATION

TIG Filler Wire Holder Fitting Instructions

- Fit the TIG filler wire holder base to location A as shown in the below image.
- Fit the TIG filler wire holder to location B as shown in the below image.

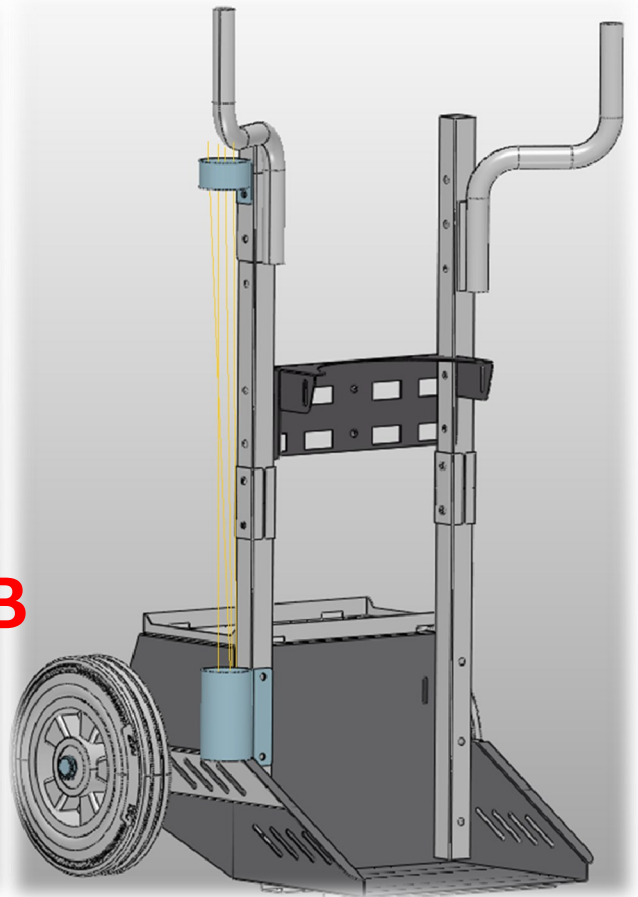
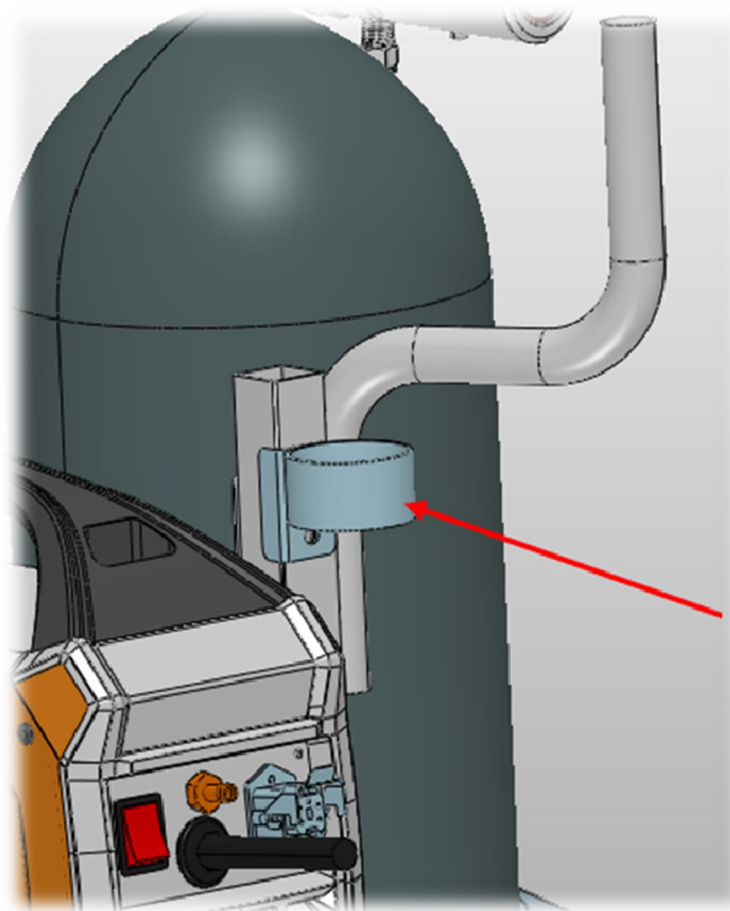
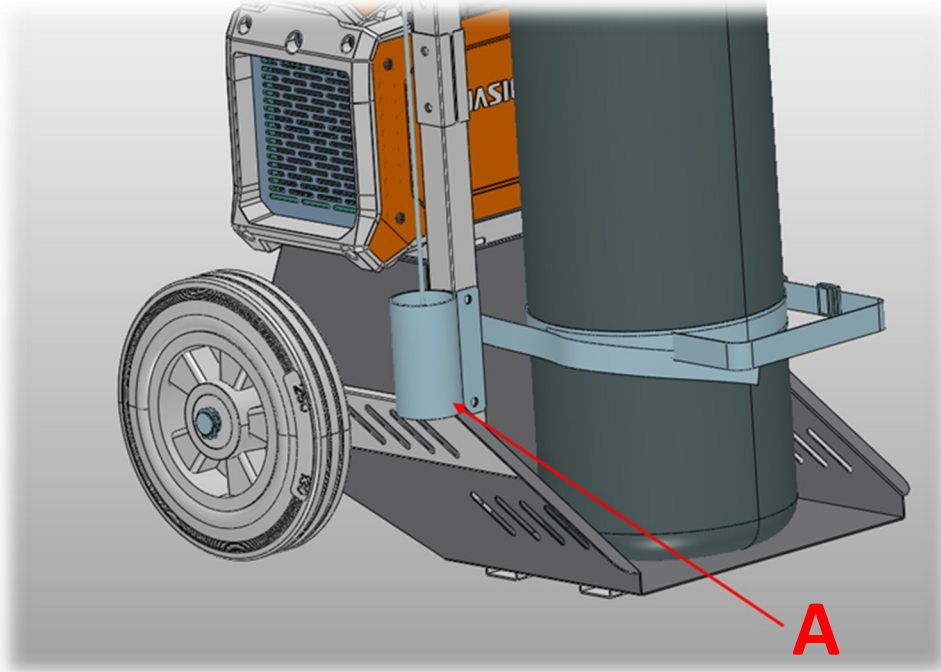



Wilkinson Star Limited

Shield Drive
Wardley Industrial Estate
Worsley
Manchester
UK
M28 2WD

+44(0)161 793 8127



Scan me!

 **JASIC®** | Passionate About Your Welding

www.jasic.co.uk September 2023 Issue 2